

30 DAYS TO COST REDUCTIONS

## Partnering with G3 Industries means real cost reductions

Why make your life more difficult dealing with six separate groups of suppliers when you can add sources without adding suppliers. Reduce your efforts and overall cost of procurement by consolidating your purchases with G3 Industries. Your competitors have already made the switch. Don't be the last to get the benefits of one-stop shopping.

- ▶ G3 Industries is a progressive manufacturer of integrated custom OEM components.
- ▶ G3 Industries is driven to reduce your cost of doing business. We achieve this through innovation, and the acquisition of new technologies and companies that facilitate our low cost, integrated supplier growth strategy.
- ▶ G3 Industries has over 200 skilled employees between two facilities, including a new state-of-the-art manufacturing facility in Mosinee, WI.
- ▶ G3 Industries acquired a successful ISO certified precision machining company in early 2006
- ▶ G3 Industries provides meets 99% of tooling requirements in-house

Give us your most challenging parts and let us show you what we can do for you!

INTEGRATED SERVICES

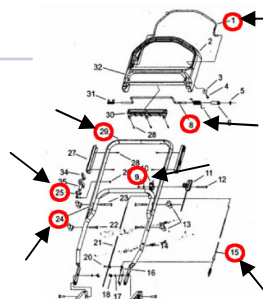

**Let our Application Engineers show you all of the parts that we can manufacture for any model you choose.**

- Welded Assemblies
- Fabricated Tubes
- Wire Forming
- Turning
- Machining
- Stamping

## Add Sources without adding Suppliers

Direct from the Manufacturer

*G3 works with all industry standard finishes and materials for each process listed!*

### WELDED ASSEMBLIES & SECONDARY OPERATIONS

- Robotic Welding: → All sizes using a 6 axis, 5'Ø auto-indexing table
- Resistance Welding: → .062 - .500
- MIG Welding: → All sizes
- Centerless Grinding: → 3-1/2" Ø
- Production Deburring: → Double end to 2-3/4" Ø; single end to 8" Ø

### FABRICATED TUBES

- CNC Bending: → Round Tube sizes: .250 -2.50 diameter  
→ Square Tube sizes: up to 2.00" X 2.00"  
→ Maximum Material wall thickness is .12 (11 Ga) at our stated maximum sizes. Greater wall thicknesses are available at tube sizes below the maximums stated.
- Piercing & Punching → All sizes available, with or without deformation
- End Treatments: → All types available
- Cutting: → Up to 3.125 @ 90 degrees, Up to 1.97 @ 45 degrees

### WIRE FORMING

- Cold Heading: → .093 - .750 Diameter
- Press Forming: → .072-1.00 Diameter.
- CNC Bending: → .120-.625 Diameter
- Threading: → 4-40 to 3/4-16, all metric sizes
- Drilling & Tapping: → All standard sizes, custom available
- Welded Guards: → Concentric & spiral, all sizes

### TURNING

- CNC Lathes: → Up to 2"Ø bar stock, up to 8"Ø chucking
- Single Spindle: → Up to 1-5/8"Ø bar stock
- Screw Machines: → 5/8" Ø -automatic screw machines, 1-1/4"Ø - CNC screw machines
- Multi-Spindle Screw Machines: → Up to 1"Ø bar stock
- CNC Swiss Screw Machines: → Up to 1"Ø bar stock
- Tube Cut-off: → Up to 7-3/8" Ø

### MACHINING

- Horizontal and Vertical Machining Centers: → Up to "football/basketball" sized components

### STAMPING

- Presses: → Up to 600 ton, .060 / .250 thickness, Strip or coil

CAPABILITIES

WIRE MAID MANUFACTURING  
ROBAND CORPORATION



INDUSTRIES

**G3 Industries, Inc. - Wire Maid Mfg.**  
1450 Don's Way  
Mosinee, WI 54455  
Phone: (715)693-1450  
Fax: (715)693-0893

**G3 Industries, Inc. - RoBand Corp.**  
N92 WI5966 Megal Drive  
Menomonee Falls, WI 53051  
Phone: (262)251-7920  
Fax: (262)251-7923